

Model : LZT

Ölçüm aralığı :10-100 lt/sa.....25-200 m3/sa.,sıvı

Bağlantı ölçüsü : DN15 ..DN 150 (dişli/yapıştırma/flanşlı)

Gövde malzemesi: SAN(Styrene acrylonitrile)

O-ring : NBR

Şamandıra malzemesi : ABS (Kırmızı-Beyaz)

Şamandıra yoğunluğu : 1 gr /cm3

Bağlantılar : ABS

Max.Basınç : ≤6 bar

Akışkan sıcaklığı : -20 °C~+60°C

Şamandıra dengeleme çubuğu (kısa tip) : 304 Paslanmaz çelik



DN (mm)	Kısa Kasa Model (Orta çubuklu)	Ölçüm aralığı	Yapıştırma bağlantı	Dişli bağlantı	Uzun Kasa Model (Orta çubuksuz)	Ölçüm aralığı	Yapıştırma bağlantı	Dişli bağlantı
15	LZT-15S10S/N LZT-15S16S/N LZT-15S25S/N LZT-15S40S/N LZT-15S60S/N LZT-15S100S/N	10-100 Lt/saat 16-160 Lt/saat 25-250 Lt/saat 40-400 Lt/saat 60-600 Lt/saat 100-1000 Lt/saat	Ø 20	G 1/2"	LZT-15S10L/N LZT-15S16L/N LZT-15S25L/N LZT-15S40L/N LZT-15S60L/N	10-100 Lt/saat 16-160 Lt/saat 25-250 Lt/saat 40-400 Lt/saat 60-600 Lt/saat	Ø 20	G 1/2 "
25	LZT-25S10S/N LZT-25S16S/N LZT-25S25S/N	100-1000 Lt/saat 160-1600 Lt/saat 250-2500 Lt/saat	Ø 32	G 3/4"	LZT-25S10L/N LZT-25S16L/N LZT-25S25L/N	100-1000 Lt/saat 160-1600 Lt/saat 250-2500 Lt/saat	Ø 32	G 3/4 "
32	LZT-32S04S/N LZT-32S06S/N	0,4-4 m3/saat 0,6-6 m3/saat	Ø 40	G 1"	-	-	-	-
50	LZT-50S04S/N LZT-50S06S/N LZT-50S10S/N LZT-50S16S/N	0,4-4 m3/saat 0,6-6 m3/saat 1-10 m3/saat 1,6-16 m3/saat	Ø 63	G 1 1/2"	LZT-50S04L/N LZT-50S06L/N LZT-50S10L/N LZT-50S16L/N	0,4-4 m3/saat 0,6-6 m3/saat 1-10 m3/saat 1,6-16 m3/saat	Ø 63	G 1 1/2 "
65	LZT-65S25S/N LZT-65S40S/N LZT-65S60S/N	5-25 m3/saat 8-40 m3/saat 12-60 m3/saat	Ø 75	2" NPT	-	-	-	-
100	LZT-100S60S/F LZT-100S90S/F LZT-100S120S/F	12-60 m3/saat 14-90 m3/saat 20-120 m3/saat	Ø 110	Flanş	-	-	-	-
125	LZT-125S150S/F LZT-125S180S/F	25-150 m3/saat 30-180 m3/saat	Ø 110	Flanş	-	-	-	-
150	LZT-150S60S/F LZT-150S90S/F LZT-150S120S/F LZT-150S150S/F LZT-150S180S/F	12-60 m3/saat 18-90 m3/saat 20-120 m3/saat 25-150 m3/saat 30-180 m3/saat	Ø 110	Flanş	-	-	-	-

NOT : S : Kısa Tüp , L:Uzun tüp ,N:Dişli tip

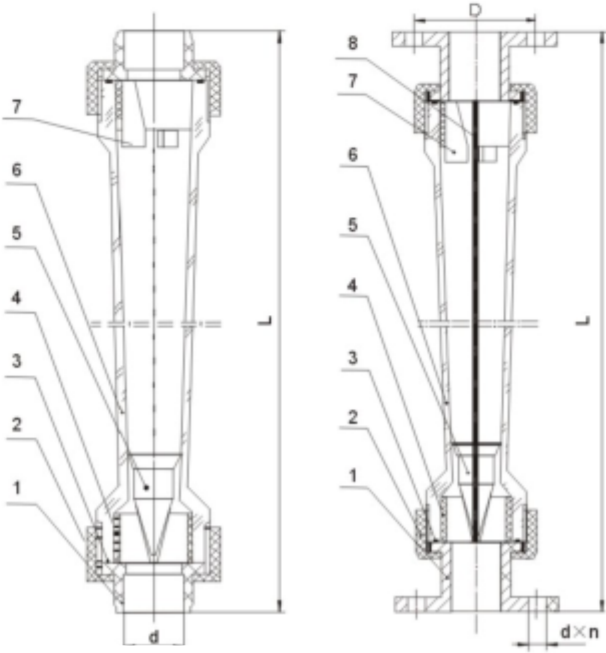

MALZEME TABLOSU		
1	Bağlantı parçası	ABS
2	Rekor	ABS
3	O-Ring	NBR
4	Alt şamandıra durdurucu	ABS
5	Şamandıra	ABS
6	Tüp	SAN
7	Üst şamandıra durdurucu	ABS
8	Sabitleme çubuğu (Kısa tip debimetrelerde kullanılır)	304SS

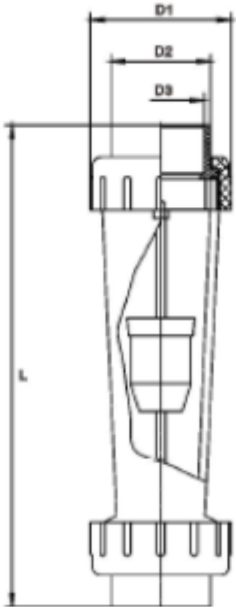

MODEL	DN	ÖLÇÜLER							
		UZUN TÜP (mm)				KISA TÜP (mm)			
		L	D1	D2	D3	L	D1	D2	D3
LZT15	15	280	45	26	20	200	44	26	20
LZT20	20	324	51	31	25	234	59	31	25
LZT25	25	380	68	39	32	234	60	39	32
LZT32	32	375	74	50	40	288	74	50	40
LZT40	40	415	88	63	50	380	87	63	50
LZT50	50	435	98	73	63	348	98	73	63
LZT65	65					430	124	88	75
LZT80	80					505	142	106	90

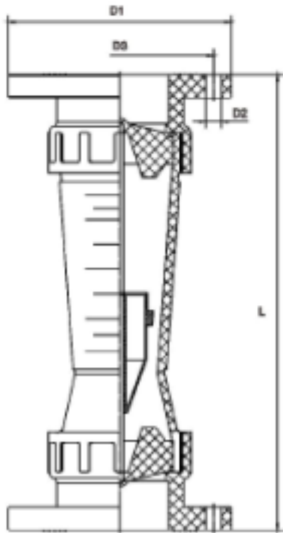

MODEL	DN	ÖLÇÜLER (mm)			
		L	D1	D2	D3
LZT15	15	245	95	Ø14X4	65
LZT20	20	288	104	Ø14X4	74
LZT25	25	290	120	Ø14X4	85
LZT32	32	380	139	Ø14X4	100
LZT40	40	465	149	Ø14X4	110
LZT50	50	445	163	Ø14X4	125
LZT65	65	525	180	Ø18X4	145
LZT80	80	600	195	Ø18X4	160
LZT100	100	550	215	Ø18X8	180
LZT125	125	550	248	Ø18X8	210
LZT150	150	550	280	Ø18X8	240

A	MUKEMMEL
B	İYİ
C	26,6 c İÇİN İYİ
D	ORTA
E	ÖNERİLMEZ
F	AUTOKATALİTİK REAKSIYON
X	BİLİNMIYOR

KİMYASAL DAYANIM TABLOSU

	PVC	PVDF	GFPPL	Polyethylene	SAN ^e	Teflon	316SS	Norprene	Ceramic	Hypalon	Viton
FERRIC NITRATE	A	A	A	E	A	A	B	A	A	B	B
FERRIC SULFATE	A	A	A	E	A	A	A	A	A	B	B
FEROUS CHLORIDE	A	A	A	A	A	A	E	A	A	B	B
FEROUS SULFATE	A	A	A	B	A	A	D	A	A	B	B
FLUOBORIC ACID	A	A	A	E	B	A	B	E	E	B	X
FLUOSILICIC ACID	A	A	A	A	B	A	B	A	E	X	B
FORMALDEHYDE, 40%	B	A	A	B	A	A	A	E	A	B	E
FORMIC ACID	C	A	A	B	E	A	B	B	A	B	E
FREON 12 (WET)	C	B	A	X	X	A	E	A	A	E	A
FURFURAL	E	B	E	X	X	A	B	E	A	X	E
GLYCERINE (GLYCEROL)	A	A	A	X	A	A	A	A	A	B	B
HYDROBROMIC ACID, 20%	A	A	A	B	X	A	E	E	C	A	A
HYDROCHLORIC ACID, 0-25%	A	A	A	B	A	A	E	A	A	B	A
HYDROCHLORIC ACID, 25-37%	A	A	A	B	B	A	E	B	A	D	A
HYDROFLUORIC ACID, 10%	C	A	A	A	B	A	C	E	E	A	A
HYDROFLUORIC ACID, 30%	C	A	B	D	E	A	C	E	E	A	A
HYDROFLUORIC ACID, 60%	D	A	B	E	E	A	C	E	E	D	A
HYDROFLUOSILICIC ACID, 20%	A	A	A	A	D	A	B	B	E	X	B
HYDROGEN PEROXIDE, 30%	A	A	A	B	B	A	B	A	X	A	A
HYDROGEN PEROXIDE, 50%	B	A	X	B	X	A	B	A	X	A	A
HYDROGEN PEROXIDE, 90%	E	A	X	D	E	A	B	B	X	D	A
HYDROGEN SULFIDE, AQ. SOL.	C	A	A	X	B	A	B	A	X	B	B
KETONES	E	A	E	X	E	A	A	E	A	E	E
LACTIC ACID	B	A	A	A	E	A	B	A	A	B	B
LEAD ACETATE	A	A	A	X	A	A	A	A	A	E	A
LUBRICATING OIL	C	B	C	D	A	A	A	E	A	D	A
MAGNESIUM CHLORIDE	A	A	A	A	A	A	B	A	A	A	A
MAGNESIUM NITRATE	A	A	A	X	A	A	A	A	A	A	A
MAGNESIUM SULFATE	A	A	A	A	A	A	A	A	A	A	A
MALEIC ACID	A	A	A	X	E	A	B	E	A	A	A
METHYLENE CHLORIDE	E	B	E	X	E	A	A	X	A	E	D
NAPHTHALENE	E	A	C	X	E	A	A	E	A	E	D
NICKEL CHLORIDE	A	A	A	A	A	A	B	A	A	B	B
NICKEL SULFATE	A	A	A	A	A	A	B	A	A	B	B
NITRIC ACID, 10%	A	A	A	A	C	A	C	A	A	A	A
NITRIC ACID, 20%	A	A	A	B	E	A	B	A	A	A	A
NITRIC ACID, 50%	A	A	C	C	E	A	C	E	A	D	A
NITRIC ACID, ANHYDROUS	E	B	E	E	E	A	B	E	A	E	B
NITROBENZENE	E	B	C	X	E	A	B	E	A	E	A
OILS AND FATS	A	A	A	X	X	A	A	X	A	X	A
OLEIC ACID	A	A	C	E	E	A	B	C	A	D	D
OLEUM, 25%	E	E	X	E	E	A	X	A	A	E	A
OXALIC ACID	A	A	A	B	D	A	C	B	A	A	A
PHENOL	C	A	B	C	A	A	B	A	A	E	A
PHOSPHORIC ACID, 0-50%	A	A	A	A	B	A	B	A	A	A	B
PHOSPHORIC ACID, 50-100%	B	A	B	B	D	A	B	A	A	A	B
POTASSIUM BICARBONATE	A	A	A	B	A	A	B	A	A	B	B
POTASSIUM BROMIDE	A	A	A	B	A	A	B	A	A	B	B

PVC = Polyvinyl Chloride, SAN = Styrene-Acrylonitrile, GFPPL = Glass-filled Polypropylene, PVDF = polyvinylidene Fluoride

A	MUKEMMEL
B	iyi
C	26,6 c için iyi
D	ORTA
E	ÖNERİLMEZ
F	AUTOKATALİTİK REAKSİYON
X	BİLİNMIYOR

	PVC	PVDF	GFPPL	Polyethylene	SAN	Teflon	316SS	Norprene	Ceramic	Hypalon	Viton
ACETIC ACID, 5%	B	A	A	A	A	A	A	A	A	A	E
ACETIC ACID, 80%	E	A	C	B	E	A	A	B	A	E	E
ACETIC ACID, GLACIAL	E	A	C	B	E	A	A	B	A	E	E
ACETIC ANHYDRIDE	E	E	A	X	E	A	D	A	A	A	E
ALUMINUM CHLORIDE	A	A	A	A	A	A	D	A	A	A	A
ALUMINUM FLOURIDE	A	A	A	X	A	A	C	A	X	A	A
ALUMINUM SULFATE	A	A	A	A	A	A	D	A	A	A	A
AMMONIA, 10%	A	A	A	B	A	A	A	A	A	A	A
AMMONIUM CHLORIDE	A	A	A	A	A	A	D	A	A	A	A
AMMONIUM NITRATE	A	A	A	X	A	A	A	A	A	A	A
AMMONIUM PERSULFATE	A	A	A	X	A	A	C	A	A	A	A
AMMONIUM PHOSPHATE	A	A	A	X	A	A	A	A	A	A	A
AMMONIUM SULFATE	A	A	A	A	A	A	B	A	A	B	B
AMYL ALCOHOL	B	A	X	X	E	A	A	E	A	B	B
ANILINE	E	A	C	D	E	A	A	E	A	B	A
AGUA REGIA	E	A	X	D	E	A	E	E	A	B	A
ARSENIC ACID	A	A	A	X	A	A	X	A	A	X	A
BARIUM CHLORIDE	A	A	A	X	A	A	C	A	A	B	B
BARIUM SULFATE	A	A	A	X	A	A	B	A	A	A	A
BEER	A	A	A	B	A	A	A	A	A	A	A
BENZALDEHYDE	E	A	C	X	E	A	A	E	A	E	E
BENZOIC ACID	A	A	A	A	C	A	B	B	A	E	A
BORAX (SODIUM BORATE)	A	A	A	D	X	A	A	A	A	B	B
BORIC ACID	A	A	A	A	A	A	A	A	A	B	B
BROMINE WATER	C	A	E	X	X	A	E	E	A	E	A
BUTYRIC ACID	D	A	A	X	D	A	B	B	A	E	D
CALCIUM BISULFITE	A	A	A	A	X	A	B	A	A	A	A
CALCIUM CHLORIDE	A	A	A	A	A	A	C	A	A	A	A
CALCIUM HYPOCHLORITE	A	A	C	A	A	A	D	A	A	A	D
CALCIUM SULFATE	A	A	A	X	A	A	B	A	A	A	A
CARBON TETRACHLORIDE	C	A	C	E	X	A	B	E	A	E	A
CARBONIC ACID	A	A	A	X	A	A	B	A	A	B	B
CHLOROACETIC ACID	A	A	D	X	E	A	E	B	A	A	A
CHLOROFORM	E	A	E	X	E	A	A	E	A	E	D
CHLOROSULFONIC ACID	C	E	E	E	E	A	D	E	A	X	E
CHROMIC ACID, 10%	A	A	A	A	A	A	B	A	A	A	A
CHROMIC ACID, 30%	A	A	A	A	A	A	B	D	A	A	A
CHROMIC ACID, 50%	E	A	A	B	D	A	C	D	A	A	A
CITRIC ACID	A	A	A	A	A	A	B	A	A	A	A
COPPER CHLORIDE	A	A	A	B	A	A	B	A	A	B	B
COPPER CYANIDE	A	A	A	X	A	A	A	A	A	X	B
COPPER NITRATE	A	A	A	X	A	A	A	A	A	B	B
COPPER SULFATE	A	A	A	A	A	A	B	D	A	B	B
CRESYLIC ACID	B	A	X	X	X	A	A	B	A	X	A
ETHYL CHLORIDE	E	A	E	X	E	A	A	C	A	D	A
ETHYLENE GLYCOL	A	A	A	X	A	A	B	A	A	B	B
FATTY ACIDS	A	A	A	E	D	A	A	C	A	X	B
FERRIC CHLORIDE	A	A	A	A	A	A	E	A	A	B	B

PVC = Polyvinyl Chloride, SAN = Styrene-Acrylonitrile, GFPPL = Glass-filled Polypropylene, PVDF = polyvinylidene Fluoride

A	MUKEMMEL
B	İyi
C	26,6 C İÇİN İYİ
D	ORTA
E	ÖNERİLMEZ
F	AUTOKATALİTİK REAKSIYON
X	BİLİNMIYOR

	PVC	PVDF	GFPPL	Polyethylene	SAN	Teflon	316SS	Norprene	Ceramic	Hypalon	Viton
POTASSIUM CARBONATE	A	A	A	B	A	A	B	A	A	B	B
POTASSIUM CHLORATE	A	A	A	B	A	A	A	A	A	B	B
POTASSIUM CHLORIDE	A	A	A	A	A	A	D	A	A	B	B
POTASSIUM CYANIDE	A	A	A	X	A	A	A	A	A	B	B
POTASSIUM DICHROMATE	A	A	A	B	A	A	A	A	A	B	B
POTASSIUM HYDROXIDE	A	A	A	A	E	A	B	A	E	B	B
POTASSIUM NITRATE	A	A	A	A	A	A	B	A	A	B	B
POTASSIUM PERMANGANATE	A	A	A	A	A	A	B	A	A	B	B
POTASSIUM SULFATE	A	A	A	A	A	A	B	A	A	B	B
SOAPS	A	A	A	C	A	A	A	B	A	B	B
SODIUM ACETATE	A	A	A	A	A	A	B	A	A	A	E
SODIUM BICARBONATE	A	A	A	A	A	A	B	A	A	B	B
SODIUM BISULFATE	A	A	A	A	A	A	A	A	A	B	B
SODIUM BISULFITE	A	A	A	A	A	A	B	A	A	B	B
SODIUM CARBONATE	A	A	A	A	A	A	B	A	A	B	B
SODIUM CHLORATE	A	A	A	A	A	A	B	A	A	B	B
SODIUM CHLORIDE	A	A	A	A	A	A	B	A	A	B	B
SODIUM CYANIDE	A	A	A	X	A	A	A	A	A	B	B
SODIUM HYDROXIDE, 20%	A	A	A	A	B	A	A	A	B	B	E
SODIUM HYDROXIDE, 50%	A	A	A	B	B	A	A	A	B	B	E
SODIUM HYPOCHLORITE	A	A	C	A	A	A	D	A	A	A	B
SODIUM NITRATE	A	A	A	A	A	A	A	A	A	B	B
SODIUM SILICATE	A	A	A	A	A	A	B	A	A	A	A
SODIUM SULFATE	A	A	A	A	A	A	A	A	A	B	B
SODIUM SULFIDE	A	A	A	A	A	A	B	A	A	B	B
STANNIC CHLORIDE	A	A	A	A	A	A	E	A	A	D	B
STEARIC ACID	A	A	C	E	E	A	A	B	A	D	A
STODDARDS SOLVENT	E	X	X	X	X	A	A	B	X	X	A
SULFURIC ACID, 0-10%	A	A	A	A	E	A	E	A	A	D	A
SULFURIC ACID, 10-75%	A	A	A	C	E	A	E	A	A	D	A
SULFURIC ACID, 75-95%	C	A	C	C	E	A	E	D	A	D	A
SULFURIC ACID, 95-100%	D	A	C	C	E	A	B	E	A	D	A
TANNIC ACID	A	A	A	B	X	A	B	B	A	B	B
TANNING LIQUORS	A	A	A	A	X	A	A	A	A	X	A
TARTARIC ACID	A	A	A	X	E	A	B	A	A	B	B
TRICHLOROETHYLENE	E	A	C	E	X	A	B	E	A	E	A
TRICRESYL PHOSPHATE	E	A	X	X	X	A	A	A	A	E	A
UREA	A	A	A	X	X	A	B	A	A	A	E
VINEGAR	A	A	A	A	A	A	A	A	A	B	B
WHITE LIQUOR (ACID)	A	A	X	X	E	A	A	A	A	X	A
ZINC CHLORIDE	A	A	A	A	A	A	B	A	A	B	B
ZINC SULFATE	A	A	A	A	A	A	A	A	A	A	A

PVC = Polyvinyl Chloride, SAN = Styrene-Acrylonitrile, GFPPL = Glass-filled Polypropylene, PVDF = polyvinylidene Flouride